



CM-OUTDOOR WEATHERPROOF Hose Storage

Detail & Submittal Sheet

Construction Specifications:

CM-Outdoor Hose Storage cabinet, constructed of 16 ga. satin coat **galvannealed*** steel with two coats of red baked enamel. Stainless steel piano hinges with chrome plated door latches. Used to store fire hose and equipment for outdoor use in industrial applications.

Product Features:

- 16 ga. galvannealed steel sheet thruout, weighs 250lbs
- Empty shelves 13" deep with 3/4" lip
- 2" slope on roof
- Rain trough over doors
- Door reinforcement at front, top and bottom
- Doors overlap tub at hinge side
- Piano hinge on both doors
- Door lock (R.H. door only)
- Chrome plated handle with 2 point catch

- Louvers on each end under bottom shelf (optional—please specify)
- Inside lips (front side)
- 3" at top 1 1/2" at bottom
- 1" at sides and bottom
- Red baked acrylic enamel

To Specify:

- Wall Mounted (with rear lugs top and bottom)
- Concrete Base Mounted (with grouting lugs at bottom)
- Support Mounted - legs packed separately (Steel fabricated legs available 24", or 36")

Options:

- Additional shelves upon request
- Suitable brackets for Accessories
- "Fire Hose" Decal

Project: _____

Specification Reference: _____

Model Number: _____ Quantity: _____

Architect: _____

Contractor: _____

Distributor: _____

Approved By: _____

Date: _____

Buy Online



Please Note: Not suitable for sea water environment. We reserve the right to alter cabinet specifications and dimensions. Please contact our local representative for updated approval drawings prior to base construction and ordering.

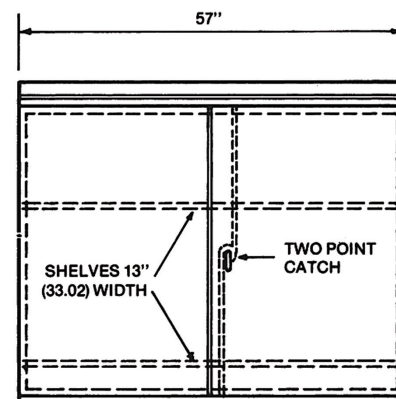
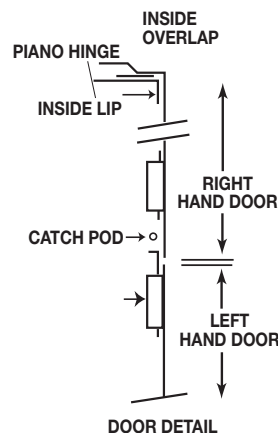
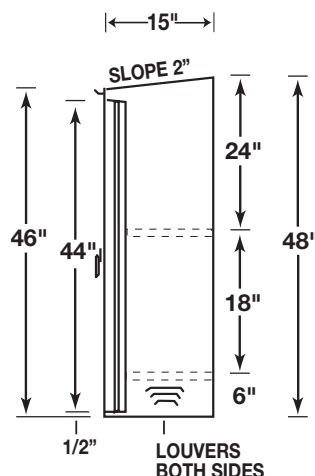

* **Galvannealed steel:** The preferred coated steel for use in architectural applications.

- Coated in zinc, heated to over 1000° F so iron is pulled from steel.
- Iron mixes with zinc coating, making it harder, more scratch-resistant, uniform appearance.
- Galvannealed steel bonds better with paint, and it is better for welding.

Example: CM-1101 shown with one shelf. Accessories not available.

✓	Mod. #	Description	Height	Shipping Weight
				Lbs.
Outdoor Weather Proof Hose Storage Cabinet				
	CM1101-12	Weatherproof Hose & Storage Cabinet - w/12" legs	60"	250
	CM1101-24	Weatherproof Hose & Storage Cabinet - w/24" legs	72"	255
	CM1101-36	Weatherproof Hose & Storage Cabinet - w/36" legs	84"	265
	CM110-W	Weatherproof Hose & Storage Cabinet - Wall mounted	48"	765

